



BEASTX

MICROBEAST **PLUS**

6-AXIS MEMS SENSOR SYSTEM FOR RC-MODELS

Version 4.2

QUICKSTART GUIDE



STUDIOX.BEASTX.COM



BEASTX.COM



WIKI.BEASTX.COM



SAFETY NOTES

- Radio controlled (R/C) helicopters are no toys! The rotor blades rotate at high speed and pose potential risk. They may cause severe injury due to improper usage. It is necessary to observe common safety rules for R/C models and the local law. You can gather information from your local R/C model club or from your national modelers association.
- Pay attention to your own safety and the safety of other people and property in your vicinity when using our product. Always fly in areas away from other people. Never use R/C models in close proximity to housing areas or crowds of people. R/C models may malfunction or crash due to several reasons like piloting mistakes or radio interference, and cause severe accidents. Pilots are fully responsible for their actions, and for damage or injuries caused by the usage of their models.
- Please read the following instructions thoroughly before the first use of your MICROBEAST PLUS and setup the system carefully according to this manual. Allow sufficient time for the setup procedure and check each step carefully. Watch for a mechanically clean and proper build of your helicopter. A wrong system setup can lead to a serious accident and damage to the model.
- Radio controlled (R/C) models consist of several electrical components. It is therefore necessary to protect the model from moisture and other foreign substances. If the model is exposed to moisture this may lead to a malfunction which may cause damage to the model or a crash. Never fly in the rain or extremely high humidity.
- When operating the helicopter with a MICROBEAST PLUS ensure there is a sufficiently large and stable receiver power supply. Because of the direct coupling of the rotor blades to the servos, without the use of a flybar mixer, the servos are exposed to increased actuating forces. In addition, because of the intermediary electronic gyro system, the servos are driven more often than with traditional use. These factors can make the power consumption increase a lot compared to a flybar helicopter. When the supply voltage falls below 3.5 volts for a short amount of time, the system will power off and reboot. In this case a crash of the helicopter is unavoidable.
- Do not expose the MICROBEAST PLUS system to extreme variations in temperature. Before powering up the system, wait some time so that the electronics can acclimatize and any accumulated condensation is able to evaporate.
- The sensors of MICROBEAST PLUS consist of highly sensitive electromechanical components. These can be damaged due to moisture or mechanical or electrical impact. Do not continue using this product, if it has been exposed to such influences, e.g. due to a crash of the model or due to overvoltage caused by a defective receiver power supply. Otherwise a failure may happen any time.
- When operating electric helicopters make sure that the electric motor cannot start inadvertently during the setup procedure. Particularly pay attention if using a single-line receiver and if the ESC is connected directly to the MICROBEAST PLUS. We recommend disconnecting the electric motor from the ESC during the setup procedure. Prior the first usage please slide the motor/pinion away from the main gear, then check that the motor does not start inadvertently when the receiver is switched on.

- When operating the RPM Governor feature of MICROBEAST PLUS it is essential to ensure that the motor cannot start by accident when making adjustment or performing preparations to start the engine. Carefully read this manual and make sure you fully understand how the RPM Governor feature is operated before making any adjustments. Also make sure the motor does not start when the radio link is interrupted or when you switch on the transmitter initially. With electric driven models do not dock the motor to the main gear unless all necessary adjustment procedures have been finished. Always maintain sufficient safety distance to the motor and other rapidly rotating components of the helicopter.
- MICROBEAST PLUS with AttitudeControl can be used as a flying aid for beginners by limiting the reaction of the helicopter to stick inputs and by stabilizing the helicopter with a electronic control loop. However, this does not provide that the helicopter can always be flown safely! By incorrect control inputs the helicopter still may crash or be placed in a position in which the pilot becomes disoriented even when using AttitudeControl. In addition, the helicopter can drift due to external influences and it is not guaranteed that the artificial horizon of the device can stabilize the helicopter at any time and recover from any orientation. Influences such as temperature fluctuations or vibrations may cause incorrect results and distort the position calculation of the system in consequence. There is no guarantee that the system will always work correctly. Only the pilot is responsible for the control of the helicopter and thus also for the use of the system. Note that the system for technical reasons will not hold the helicopter absolutely to the point. The unstable tendency of a helicopter will cause the model to fly in a certain direction even when using AttitudeControl. External influences such as wind can further strengthen this effect. In addition measurement inaccuracies of the sensors can distort the position determination slightly. You must always be able to turn off the system immediately and be able to take over full control of the helicopter.
- We suggest you to seek the support of an experienced helicopter pilot before you undertake the first flight of your model. Additionally, flight training with a R/C simulator can help make flying easier and more enjoyable. Ask your local dealer if you need technical support or if you observe problems during the usage of our system.
- AttitudeControl can help to facilitate flying of model helicopters by briefly passing over control to the system if the pilot becomes disoriented. By using the built-in artificial horizon the helicopter can be brought to a nearly horizontal position so that the pilot gains time to reorient. Thus, there can be no assurance that the model is saved from a crash in general. Depending on the current attitude and the speed of the model and depending on how fast the AttitudeControl is activated, the model may crash before or while the system tries to recover. In addition, the helicopter can drift due to external influences and it is not guaranteed that the artificial horizon of the device can stabilize the helicopter at any time and recover from any orientation. Influences such as temperature fluctuations or vibrations may cause incorrect results and distort the position calculation of the system in consequence. Strictly observe the general safety rules for dealing with RC models and do not totally rely on the system. The pilot is responsible for the control of the helicopter and thus also for the use of the system. You must always be able to turn off the system immediately and be able to take over full control of the helicopter.



MICROBEAST PLUS

6-AXIS MEMS SENSOR SYSTEM FOR RC-MODELS

QUICKSTART GUIDE V4.2

Dear customer,
thank you for purchasing our product.

MICROBEAST PLUS is a high-end flybarless system for RC helicopters that has been developed in Germany using latest technology and setting high standards. This system can be used with nearly any size and type of RC helicopters and besides using it as flybarless stabilization system it offers additional features that can make flying helis even easier and comfortable.

To program MICROBEAST PLUS we consciously decided against using a tiny display that might be hard to read or using an external programming device such as a smart phone or PC software. The „EasySetup“ concept allows to setup the helicopter in a very short amount of time and without the need of additional devices which you might have forgotten at home when on the flying field. You can setup your helicopter anytime and anywhere and you're ready for take off within a few minutes.

This Quickstart Guide is a clearly arranged guide that will lead you step-by-step through the basic flight setup. Please follow this guide carefully and make sure to read the attached safety notes. For a detailed instruction manual and a lot more details, tips, tricks and notes about the product please visit

WIKI.BEASTX.COM

Designed for **STUDIOX**

StudioX allows to edit, save and load the device setup by using a PC. Additionally it can be used to register your device and acquire optional features. Also it allows to perform very special setups like such as a virtual swashplate rotation for multiblade rotorheads. To connect your MICROBEAST PLUS to the computer the optional available USB2SYS interface is required.

StudioX can be downloaded from:

STUDIOX.BEASTX.COM



This guide only is intended to be used with MICROBEAST PLUS firmware version 4.2.x!

You can see what firmware version your MICROBEAST PLUS is running when it is powered on. First the device carries out a brief LED test. Then for about 3 seconds the Status-LED lights red while the Menu-LEDs **A** - **G** display the first digit of the firmware version and the LEDs **H** - **I** the second digit of the firmware version.



Firmware version: 4.2.x

In the left row Menu-LED **G** stands for major version „4“. In right row Menu-LED **I** shows minor version „2“.

1. HARDWARE INSTALLATION

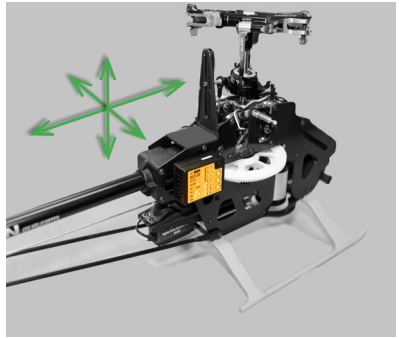
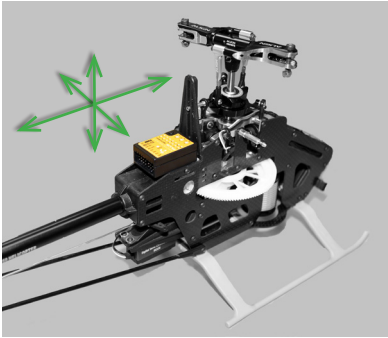

You can position MICROBEAST PLUS flat or upright on the helicopter. The large socket must point to the front or to the rear of the helicopter. The small white socket must be aligned with the longitudinal axis.

The sensor axis (housing edges of the device) must be aligned exactly parallel to all three rotation axis of the helicopter. However, it is allowed to position the device offset from the rotation axis.

In summary there are 8 mounting orientations possible:

1. flat, sticker on top, socket pointing to front
2. upright, button up, socket pointing to front
3. flat, sticker showing to ground, socket pointing to front
4. upright, button down, socket pointing to front
5. flat, sticker on top, socket pointing to rear
6. upright, button up, socket pointing to rear
7. flat, sticker showing to ground, socket pointing to rear
8. upright, button down, socket pointing to rear

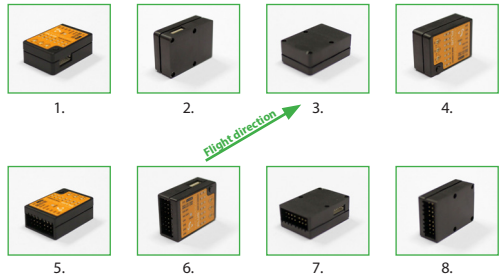

Use one of the supplied 3M gyro pads to stick the device to your helicopter. The device housing must not directly touch the chassis of the helicopter. When connecting and laying out the servo and receiver wiring later onwards please make sure the wires do not pass tension to the MICROBEAST PLUS. It is not recommended to bundle or tie down the leads close to the MICROBEAST PLUS device.

2. CONNECTING THE RECEIVER

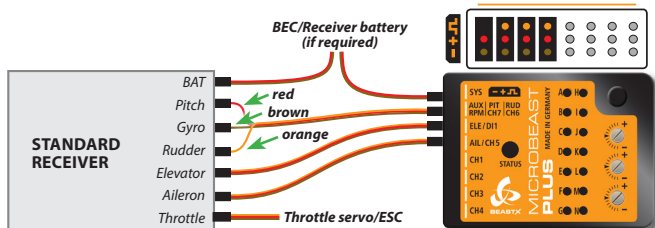

The illustrations are only intended as examples! The function assignment of the transmitter determines which channel on the receiver controls which function.

The assignment of functions to the radio channels is mentioned in the manual of your radio system. Also you may find out the function assignment by checking your transmitter's servo monitor. The connectors of MICROBEAST PLUS are assigned to the functions as follows:

All|CH5 = Aileron, ELE|DI1 = Elevator, RUD (orange wire) = Rudder, PIT (red wire) = Thrust, Aux (brown wire) = Gyro gain

The wires for aileron and elevator additionally transfer the power between MICROBEAST PLUS and receiver.

Using a Single-Line receiver all channels/functions are transferred by one single connection wire. This allows to use even more than 5 channels, i. e. for controlling the nitro RPM Governor, AttitudeControl function and/or additional servo output channels.

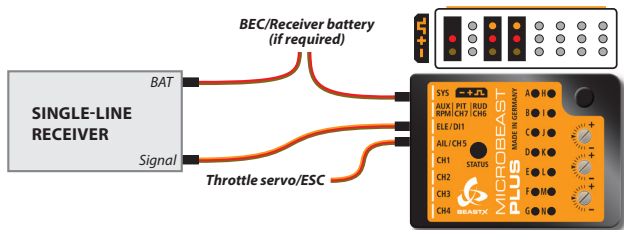

Supported receivers/transmission protocols:

- SRXL: JR® XBus (Mode B), Multiplex® SRXL (V1+V2), Jeti® UDI, Graupner/SJ® HOTT SUND, Spektrum® SRXL
- Futaba® SBus
- Spektrum® remote satellite (DSM2/DSMX)
- JR DMSS remote satellite (JR RJ01)
- PPM serial signal (SPPM)

Using a single remote satellite is only recommended for 450 size helis or smaller! For larger helis you may use a SRXL compatible Single-Line receiver.

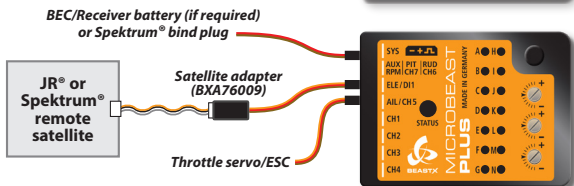

Always make sure the power supply is stable and dimensioned sufficiently for the intended application. If possible always connect the power source directly to MICROBEAST PLUS. Especially when using standard size servos it is recommended to use more than one power supply cable in parallel to preserve a stable voltage and to reduce power loss due to connection resistance. The additional supply cables may be connected to free receiver ports. We recommend to use MICROBEAST PLUS HD which offers a low resistant high-power input and which is well suited for larger model helicopters.

To initiate **bind procedure on a single Spektrum® remote satellite** connect the Spektrum bind plug to SYS port. When using a DSMX remote satellite push and hold the button and turn on power while still holding the button down. The LED on the satellite will flash together with Menu LED **1** on the MICROBEAST PLUS. When binding a DSM2 remote satellite do not touch the button but only power on the device. The LED on the satellite will flash together with Menu LED **1**. Initiate the bind procedure on the transmitter. Power off and remove the bind plug when finished successfully.

To bind the JR® RJ01 remote satellite initiate the bind procedure on the transmitter and power on the MICROBEAST PLUS. The remote satellite will bind instantly. Connecting a bind plug or similar is not necessary.

3. MICROBEAST PLUS HD

Input voltage range: 3,5 – 8,4 Volts.

MICROBEAST PLUS HD in first line was designed for 550 size helis and larger which use standard size servos with high current consumption. Here you can connect the power supply directly to the additional high-power input which reduces voltage loss due to contact and wiring resistance significantly when high currents are flowing.

Always use the supplied power cable as connector between battery and MICROBEAST PLUS HD. It is not recommended to directly plug in the battery at the device. Continuous plugging and unplugging can cause the overlying servo plugs getting unplugged accidentally or cause the adhesive gyro pad to get loose!

Receiver and servo plugs are connected to the ports on top of the unit, similar as described for the standard (non-HD) MICROBEAST PLUS.

Receiver battery or BEC

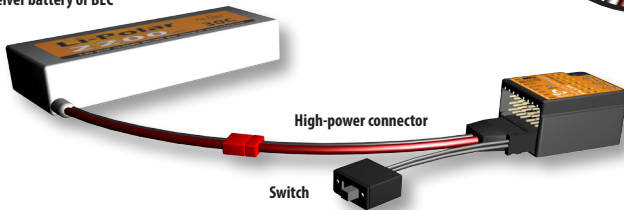

Using the switch is optional. The device can also be operated without switch. Then it will be ON all the time. **Anyhow, never connect anything else than the switch to the switch port. Otherwise the device will get damaged!**

⚠ When switched off MICROBEAST PLUS HD consumes a very low amount of standby current. Therefore always completely disconnect the battery from the system if you do not use the model for an extended period of time to prevent the supply battery from getting discharged and damaged in consequence.

⚠ MICROBEAST PLUS HD does not supply an internal voltage regulation! The voltage that is applied to the high power connection port will directly be passed to the servo and receiver connections. Only use electronic components (servos and receiver) that are designed for your power source.

⚠ Using the high power connection port is not a must. You can also use MICROBEAST PLUS HD in a conventional manner by powering the unit from the receiver ports in the top row. However, using the electronic power switch system is not possible then.

4. PREPARING YOUR TRANSMITTER

Create a new helicopter model memory in your transmitter that supplies different flight modes for controlling throttle, pitch and the tail gyro gain in different flight situations.

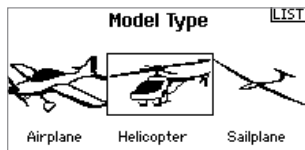
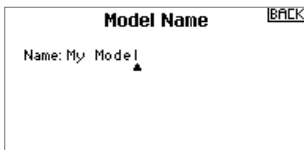
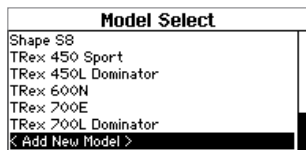

You must not use any mixing functions on the output channels! Especially it is not allowed to use mixing functions for the swashplate servos. Deactivate all output channels that are not used. In the basic configuration we only need pitch, aileron, elevator, rudder, throttle and one channel to adjust the tail gyro gain.

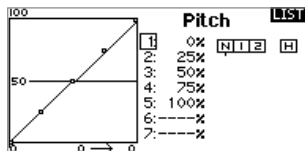
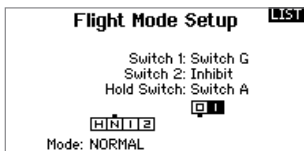
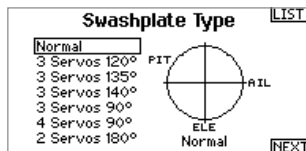

Each control function must exactly control one output channel. The servo throws must be set to 100% and all trims and sub trims must be zero. For the basic setup do not change the pitch curves yet. The throttle curves and throttle servo settings can be adjusted as necessary for this model in case you do not intend to use the internal RPM Governor function of MICROBEAST PLUS. If you want to use the integrated RPM Governor function also do not touch the throttle settings yet.

Only the pitch channel must be controlled when moving the thrust stick. The same applies to aileron, elevator and rudder.

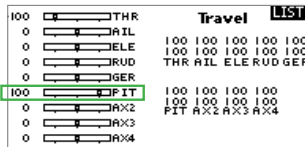
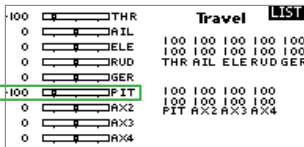

⚠ With electric driven models remove the motor from the main gear when performing the basic setup for safety reason! Additionally deactivate the throttle by using the „Throttle HOLD“ switch, so the motor won't start to turn when moving the thrust stick.

When flying a **nitro or gasser heli** remove the servo horn from the throttle servo before first power up to prevent jamming of the servo due to wrong servo setup.

5. RECEIVER SETUP

To enter Receiver menu MICROBEAST PLUS must be switched off completely. Push and hold the button before and while powering on. Menu LED **A** will start to flash instantly.

At menu point **A** choose which type of receiver/transmission protocol is used. The color and state of the Status LED indicates which type is currently selected. By repeatedly **pressing and holding the button** you can switch between the receiver types. **Briefly pushing the button** will skip to menu point **B** or to the menu end in case you selected the „Standard“ type.

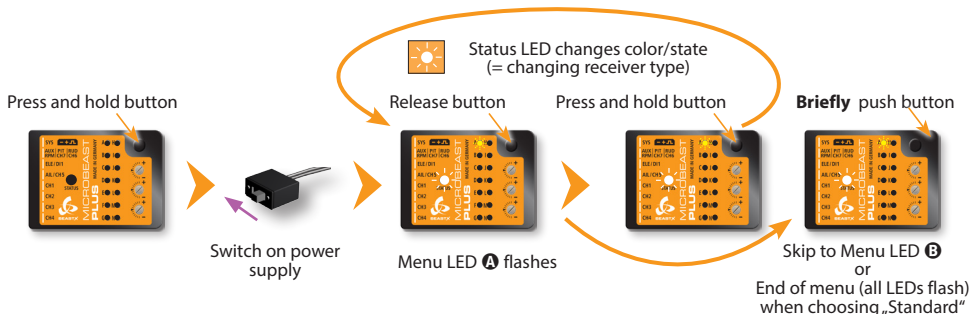

Status LED	off	flashing purple	purple	flashing red	red	flashing blue
A Receiver type	Standard	JR® R/J01 satellite	Spektrum® satellite	S-Bus®	SRXL®	SPPM

Single-Line receiver (Status LED not off)

If the correct receiver type has been selected and transmitter and receiver are bound and switched on and if the receiver is sending a valid signal on the Single-Line output, the Status LED must light up in **blue** color at menu point **B**. Again press and hold the button here to load the default function assignment that has been preset for the selected radio system (see next page). Alternatively you may program a different function assignment manually in case the default assignment does not work with your transmitter's function layout. How this works in detail you can read from the detailed instruction manual which you can see at wiki.beastx.com.

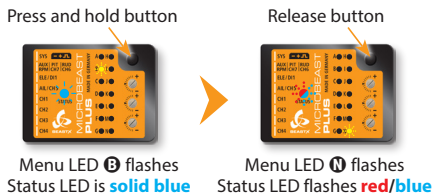

Warning! At menu point **N (Throttle failsafe position) the throttle output CH5 is activated!** Move the throttle to the desired failsafe position which will be set in case the Single-Line connection is interrupted or gets disconnected.

Briefly push the button to save all the receiver settings now. The end of menu is reached which is indicated by all menu LEDs flashing.

	JR® RJO1 satellite	Spektrum® satellite	Futaba® S-BUS	PPM serial signal (SPPM)
Channel*	Function	Function	Function	Function
1	Throttle (CH5)	Aileron	Pitch	
2	Aileron	Elevator	Aileron	
3	Elevator	Throttle (CH5)	Elevator	
4	Rudder	Rudder	Rudder	
5	Gyro gain	Gyro gain	AttitudeControl	
6	Pitch	Pitch	Throttle (CH5)	
7	AttitudeControl	AttitudeControl	Gyro gain	
8	RPM Governor***	RPM Governor***	RPM Governor***	
9	Auxiliary (CH6)	Auxiliary (CH6)	Auxiliary (CH6)	

SRXL				
	BEASTRX®	Multiplex® SRXL JR® XBUS Mode B JETI® UDI	Graupner® SUMD	Spektrum® SRXL
Channel*	Function	Function	Function	Function
1	Aileron	Aileron	Pitch	Throttle (CH5)
2	Elevator	Elevator	Aileron	Aileron
3	Throttle (CH5)	Rudder	Elevator	Elevator
4	Rudder	Pitch	Rudder	Rudder
5	Gyro gain	Throttle (CH5)	AttitudeControl**	Gyro gain
6	Pitch	Gyro gain	Throttle (CH5)	Pitch
7	AttitudeControl**	AttitudeControl**	Gyro gain	AttitudeControl**
8	RPM Governor***	RPM Governor***	RPM Governor***	RPM Governor***
9	Auxiliary (CH6)	Auxiliary (CH6)	Auxiliary (CH6)	Auxiliary (CH6)

When using SRXL MICROBEAST PLUS will detect automatically which brand of receiver is used and will choose the appropriate channel assignment accordingly.

* Channel designation of Spektrum® transmitters: THR, AIL, ELE, RUD, GER, PIT, AX2, AX3, AX4

** only applicable with ProEdition firmware. Otherwise this channel controls CH6 Auxiliary output instead of channel 9

*** only for models with nitro or gas engine

Receiver with „Standard“ 5-wire layout (Status LED off)

Here the function assignment is simply determined by the order of physical connection of the wires to the receiver outputs. Assignment by software is not provided and will not appear when choosing this type of receiver. Here the AttitudeControl function (optional) will be controlled using the tail gyro gain channel. The RPM Governor function can't be used in combination with this type of receiver. When choosing „Standard“ (Status LED **off**) at menu point **A** and briefly pushing the button, receiver setup is finished and menu point **B** will not appear!

6. SETUPMENÜ

Switch on transmitter



Switch on power supply



Self test



Status LED lights up
red->blue->purple

Firmware version: 4.2.x



Calibration of radio channels



Calibration of sensor rest positions



Operation mode



Do not move sticks on the radio!

Do not move the helicopter!

Status LED lights up
blue or purple

Entering Setup menu

Press and hold button



Operation mode
(Status LED is
blue or purple)

Keep button pressed down



Menu LED **A** flashes

Release button



Menu LED **A** lights up solid
(= Setup menu point **A**)

Setup menu point **A** - Device orientation (Menu LED **A** solid lit up)

Check the selected device orientation and change it if necessary by (repeatedly) moving the rudder stick into one direction until the Status LED color corresponds to the real device orientation. Then briefly push the button to save the setting and to proceed to the next menu point.



Status LED shows currently selected device orientation



Status LED changes color/state
(= Changing device orientation)



Move rudder stick left or right

Press button briefly



Status LED shows currently selected device orientation



Menu LED **B** lights up solid
(= Setup menu point **B**)

Flight direction ↗

Large socket points to nose of the heli

Large socket points to tail of the heli



Status LED **off***



Status LED **flashing purple**



Status LED **purple**



Status LED **flashing red**



Status LED **red**



Status LED **flashing blue**



Status LED **blue**



Status LED flashing **red/blue**

Setup menu points **B**, **C** and **D**

The currently selected swashplate servo update rate (**B**), rudder servo update rate (**D**) and rudder servo center pulse (**C**) are indicated by the color and state of the Status LED at each menu point. By moving the rudder stick to one or another direction you can change between the available options (if necessary). Briefly pressing the button will save the selected option and move to the next menu point.

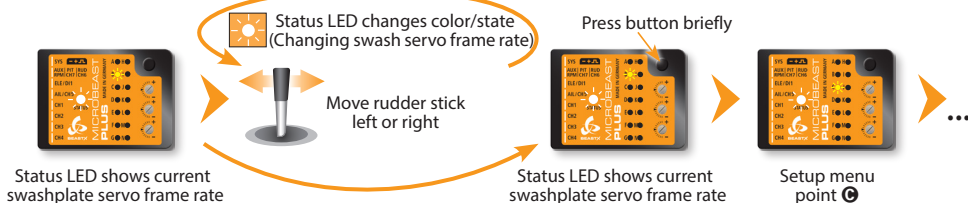

Status LED	off	purple	flashing red	red	flashing blue	blue
B Swashplate servo update rate	User defined	50 Hz*	65 Hz	120 Hz	120 Hz	200 Hz
C Rudder servo center pulse	User defined	960 μs	-	760 μs	-	1520 μs*
D Rudder servo update rate	User defined	50 Hz*	120 Hz	270 Hz	333 Hz	560 Hz

⚠ If you don't know what the maximum update rate that is tolerated by your servos never use more than 50Hz. The higher the update rate the better it is for the flight performance of MICROBEAST PLUS but you must check the servo specifications before increasing the update rate. Otherwise the servos may get damaged! See WIKI.BEASTX.COM for a list with parameter examples for most servo types commonly used in flybarless helicopters.

Setup menu point ③ - Rudder servo limit

Plug the rudder servo connector into **CH4** output of MICROBEAST PLUS. Put the servo arm on the servo so that it forms roughly an angle of 90 degrees with the rudder linkage rod and adjust the length of the linkage rod as described in the helicopter manual.

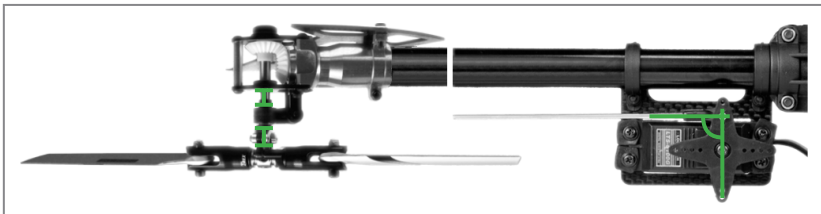

Push and hold the rudder stick into one direction to move the rudder servo and release the stick when the servo reaches the maximum or minimum allowed servo throw. Using the rudder stick you can reposition the servo at any time to adjust the exact servo limit. If you do not touch the rudder stick for several seconds the current servo position will be saved as maximum or minimum (the Status LED will flash and then light up solid in **blue** or **red** color). Then move the servo to the opposite direction and wait until also this position gets stored (Status LED becomes **purple**).



Menu LED ③ solid
Status LED off

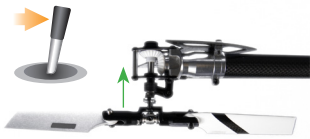

Use rudder stick to move the servo to the maximum allowed deflection

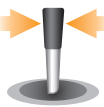

Release rudder stick



Status LED
blue or **red**

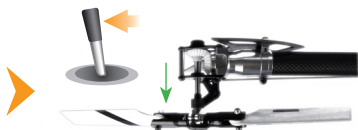

Use rudder stick to move the servo to the minimum allowed deflection

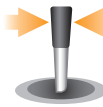

Release rudder stick

Press button briefly



Status LED
purple



Menu LED ⑦ solid
(= Menu point ⑦)

When moving the rudder stick check if the servo is moved into the correct direction so that the helicopter will be moved correctly in flight. If this is not the case use the servo reverse function of your transmitter and reverse the channel output that controls the rudder function.

Setup menu point ⑤ - Tail gyro direction

Lift the helicopter at the rotorhead and turn it on the vertical axis by hand. Observe in which direction the rudder servo moves the tail rotor when turning the heli. The tail rotor must produce thrust against the direction of movement so that the rotation will be stopped by the gyro in flight. For example if you move the helicopter's nose to the left the gyro must steer to the right similar as you would move the rudder stick to the right manually.

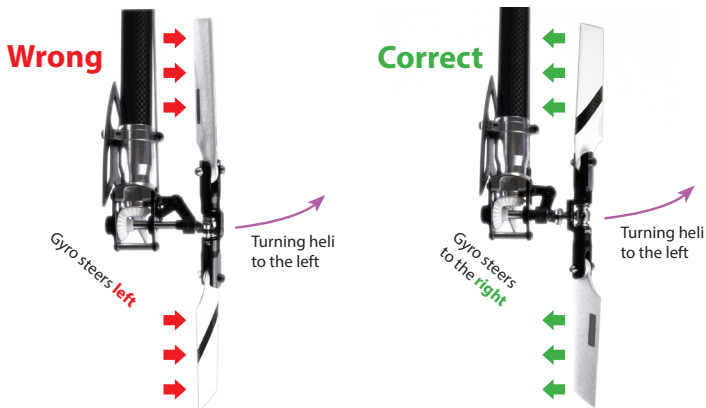

Note: These pictures are only exemplary. Check your helicopter's manual to find out which direction your tail rotor has to move.

If necessary reverse the tail gyro direction by briefly pushing the rudder stick into one direction at menu point ⑤ (Status LED color will change). When finished briefly push the button to proceed with setting up menu point ⑥.

Setup menu point ⑥ - Swashplate servo trim

Plug all three swashplate servos to the outputs marked with **CH1** to **CH3** in the order as shown below. Then put the servo arms on the servos so that they form roughly an angle of 90 degrees with the linkage rods.

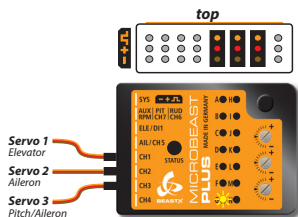
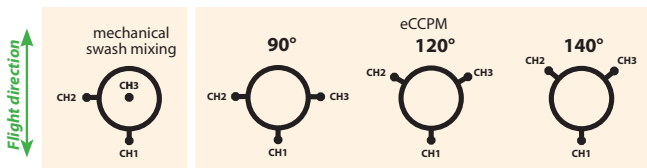

By moving the rudder stick into one direction repeatedly select one servo after another and adjust each servo's center position by moving the elevator stick forwards or backwards so that the servo arm is positioned exactly 90 degrees to the linkage rod. The servo number that is currently selected and that can be trimmed at the moment is indicated by the Status LED color.



Status LED off
(= no servo active)

Choose one of the servos
connected at CH1 - CH3



Move rudder stick
left or right



Status LED color indicates
selected servo number



Move elevator stick to adjust servo
center position



⚠ Check all servo positions by selecting each servo once even when the servo arms are perfectly positioned when Status LED is off.

When the servos are adjusted perfectly **let one servo selected** (only the electrical trim positions are important and are used in the further steps) and adjust the linkage rods going from servos to the swashplate and from the swashplate to the blade grips.

The swashplate must be leveled and centered on the main shaft and the blade grips should be set to 0° pitch. Then briefly push the button to get to menu point ④.

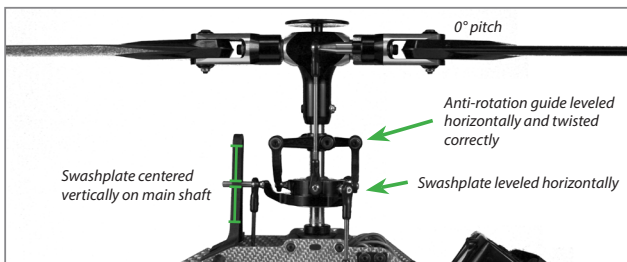

If necessary adjust the swashplate anti-rotation guide so that there is no swashplate phasing (only applies to 2-blade rotorheads).

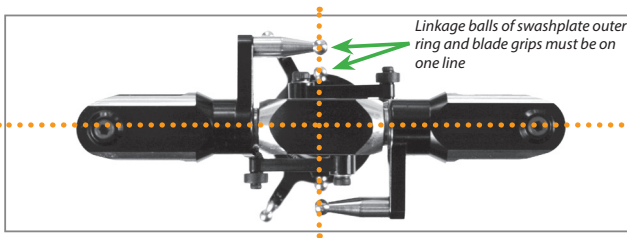

Setup menu point ① - Swashplate mixing type

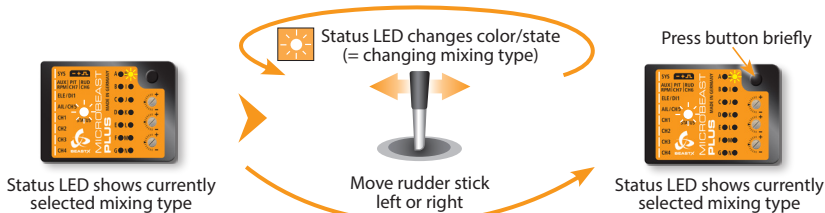

Status LED	off	purple	flashing red	red	flashing blue	blue
① Swashplate mixing type	User defined	mechanical	90°	120°	140°	135°/140° (1:1)

Setup menu point ② - Swashplate servo directions

Only move the thrust stick and check if all servos push the swashplate up and down simultaneously. If this is not the case move the rudder stick into one direction once to switch to the next servo configuration and try again. Repeat this until the servos move the swashplate correctly. There are four possible configurations and only one will be correct.

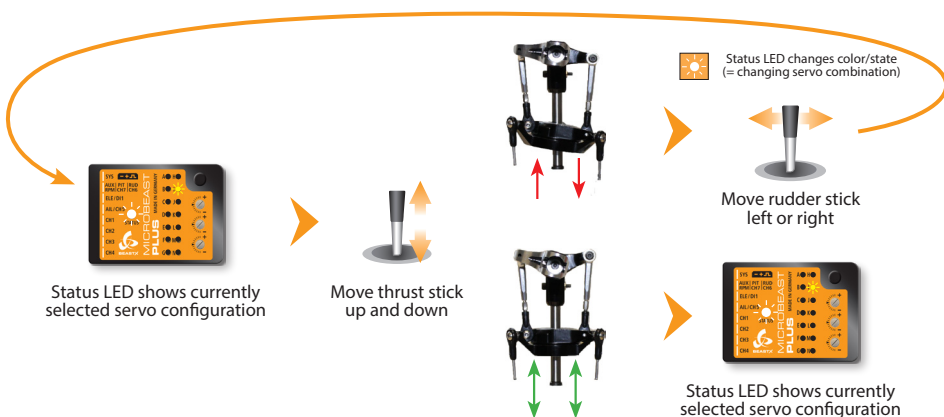

Now also check if the sticks are moving the swashplate in the correct directions. If one or more directions are wrong use the servo reverse function of your transmitter to reverse the channel output for the channel which controls the specific function.

Do not use the servo reverse function of MICROBEAST PLUS to change stick directions!

When the swashplate can be controlled as expected briefly push the button to skip to menu point ③.

Setup menu point ① - Swashplate servo throw

Align rotorhead and rotorblades in parallel to the helicopter's longitudinal axis. Attach a pitch gauge/level meter to one of the rotor blades in order to **measure aileron pitch**.

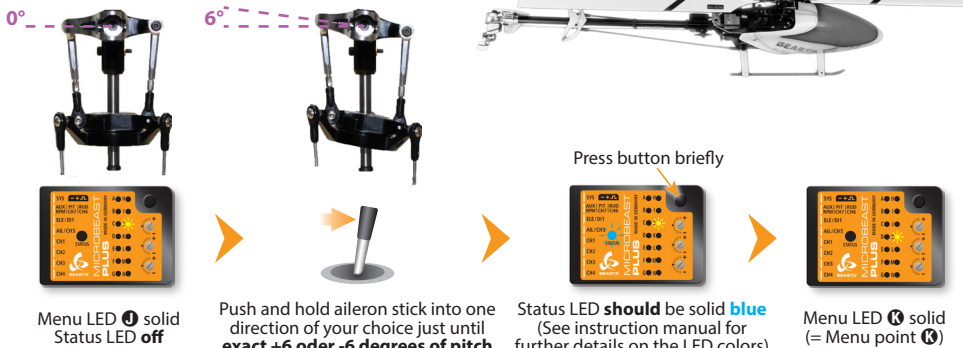

Setup menu point ② - Collective pitch

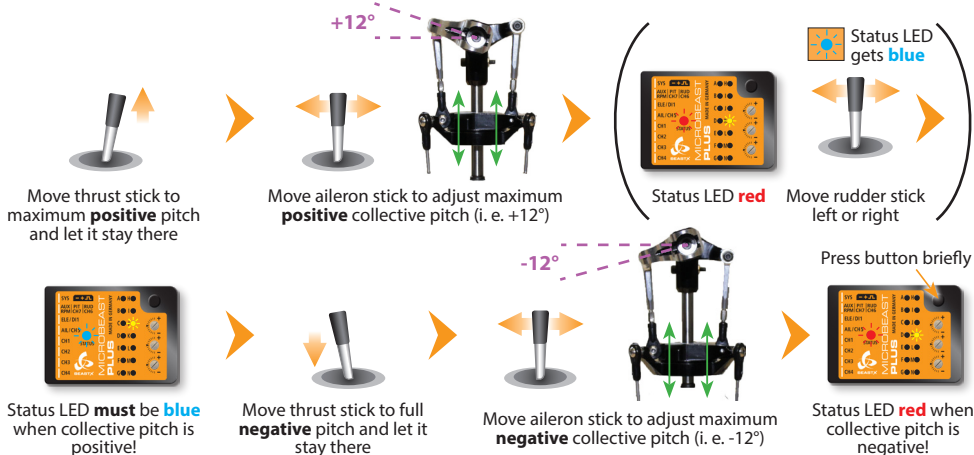

Setup menu point **L** - Swashplate servo limit

You can remove the pitch gauge now! Simultaneously move the sticks for thrust, aileron and elevator to the maximum deflection and check if the servos, swashplate or linkages get jammed in a certain position. By pushing and holding the rudder stick left or right you can increase or decrease the limit for the servos! Adjust the limit so that the servos just don't get jammed in any possible stick position but don't limit the servos more than necessary.



Menu LED **L** solid
Status LED shows the
amount of limiting

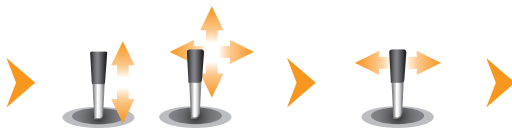

Move thrust, aileron and
elevator sticks **carefully** to
maximum deflection!

Move rudder stick to adjust
the servo limit



Press button briefly

Status LED **should** be
solid **blue**
(See instruction manual
for further details)

Setup menu point **M** - Swashplate gyro directions

Lift the helicopter at the rotor head and tilt it by hand forwards and sideways. Watch how the gyro is correcting the swashplate. **The system has to steer against the movement of the helicopter keeping the swashplate level.** If the swashplate tilts into the direction of movement you have to reverse the compensation direction for this axis.

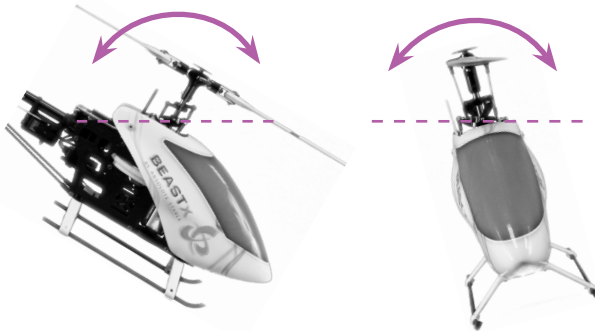

Status LED shows current
swashplate gyro directions

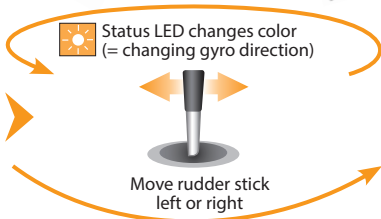

Status LED changes color
(= changing gyro direction)

Move rudder stick
left or right



Press button briefly

Status LED shows current
swashplate gyro directions

Setup menu point **N** - Internal RPM Governor

This menu point is only accessible if you're **not using a Standard type receiver**! Otherwise pressing the button at menu point **N** will exit the menu and lead back to operation mode.

Enable the internal RPM Governor function by choosing the type of drive system of your helicopter. If you're using the governor function of the ESC or an external governor or if you want to fly without headspeed governing at all, select „Governor off“.

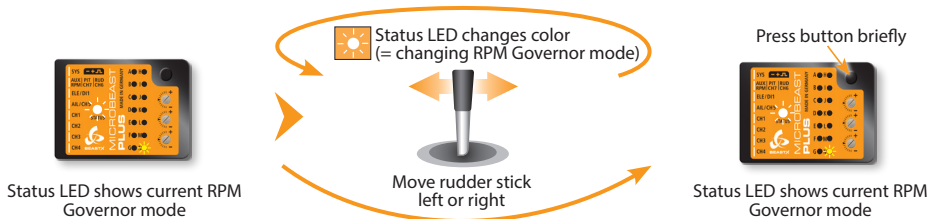

Status LED	off	red	blue
N Internal RPM Governor	Governor off*	electric heli	nitro/gas heli

When you're using the RPM Governor of MICROBEAST PLUS now connect the RPM sensor (i. e. magnetical, optical or brushless phase sensor) or the wire for RPM signal of your ESC to the white sensorport on the long side. For this you may need the optional available BXA76401 adapter.

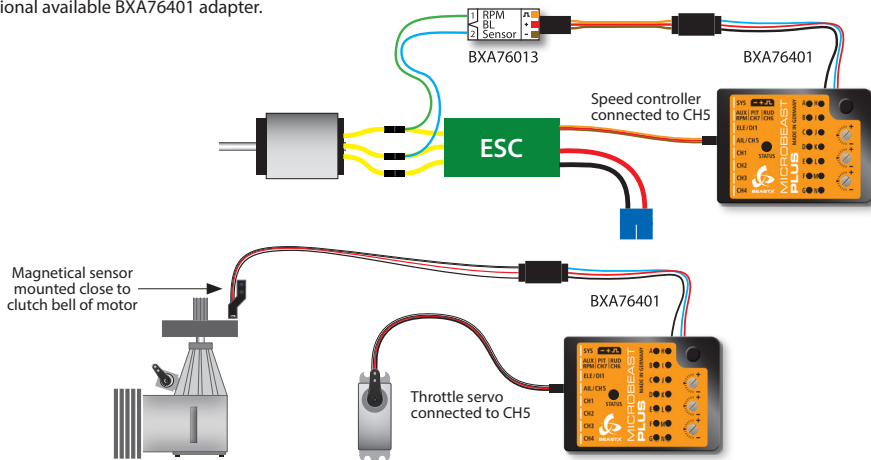

7. GOVERNOR SETUP MENU

Governor menu point **A** - Test mode (Menu LED **A** flashing slowly)

If the RPM Governor was activated at Setup menu point **U** (setting „electric“ or „nitro/gas“ heli) you will access the Governor menu immediately afterwards. At menu point **A** we check if the rpm sensor is functioning properly and if the rpm sensor wire is connected correctly.

Electric heli with brushless phase sensor



Menü LED **A** flashes
Status LED off



Carefully add throttle until motor starts to turn
Status LED is solid **red** as long as motor turns

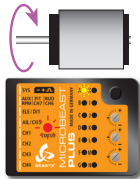

Motor off
position



Press button briefly



Menü LED **A** flashes
Status LED off

Nitro/Gas heli



Menu LED **A** flashes
Status LED off

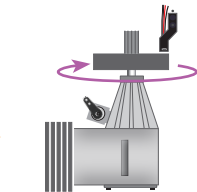

Turn clutch bell by hand



Status LED solid **blue**
when magnet triggers sensor



Status LED **off** when no
magnet under sensor or when
second magnet is passed
(this may vary)

Additionally when using a helicopter with combustion engine you may adjust the throttle servo positions in the transmitter (servo throw and servo center) and setup the throttle on the heli (throttle linkage rod length and servo arm position) if necessary. Attach the servo horn at thrust mid stick position. The throttle linkage must form a right angle with the servo horn. Adjust the length of the linkage according to the instructions of the helicopter so that it also is positioned perpendicular to the linkage lever at the carburetor. The carburetor must be opened halfway (note the markings on the carburetor!). Then adjust the servo throw so the carburetor can be fully opened and fully closed without jamming the throttle servo.

Thrust in mid
stick position



Servo arm and throttle
lever in parallel and
perpendicular to linkage rod

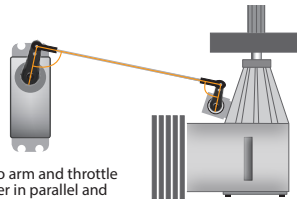

Governor menu point ③ - Motor off/Idle position

Using an electric heli move the throttle to the position at which the motor is just before to start running, i.e. by adding throttle until the motor starts to turn and then reducing the throttle a little. With a nitro/gas heli move the throttle to a stable idle position.



Menu LED ③ flashes
Status LED off

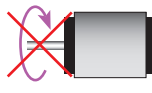

Move throttle to position at which the motor is just before to start running (electric heli) or idle position (nitro/gas heli)

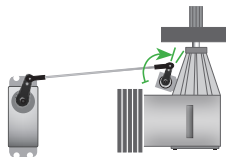

Press button briefly



Status LED blue
when throttle
position registered

Governor menu point ④ - Full throttle position

Move throttle to maximum position. **Note:** In electric governor mode the throttle input will not be passed to CH5 output to prevent from motor damage by running the motor without load! Thus, you have to check before that the full throttle position runs the motor at maximum speed in reality, i.e. by correctly programming your throttle end points in the transmitter or ESC.



Menu LED ④ flashes
Status LED off

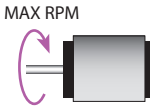

MAX RPM
Move throttle to maximum position

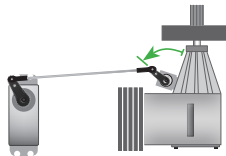

Press button briefly



Status LED blue
when throttle
position registered

Governor menu point ⑤ - Transmitter setup

Here we can set the desired rotor headspeed and throttle curves. The Status LED can be used to verify the transmitter setup. When using an **electric heli** the throttle is completely independent from the thrust stick. The throttle curves are set to horizontal lines which stand for a certain headspeed and governor operation mode. Using the flight mode switch you can switch between the different curves/rpm presets in the transmitter.

Motor off

- Throttle 0% over the entire range

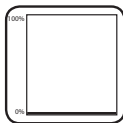

Status LED off

Idle up

- Throttle set between 15% and 100% equals headspeed of 600 - 4000rpm
- +5% = +200rpm

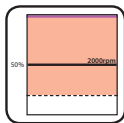

Status LED red
or purple

Autorotation

- Motor off
- When switching back to idle up motor will restart quickly

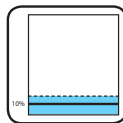

Status LED blue

The RPM Governor for **nitro/gas models** can be operated in two different ways: One possibility is to operate the governor using the throttle channel similar to the electric mode. Only difference here is that the the range below 50% throttle is used to manually control the throttle servo, i. e. for starting the motor. The range above 50% activates the governor and presets a specific rotor headspeed just like in electric mode.

Manual control

- Range between 0% und 50% directly controls the throttle servo

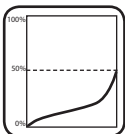

Status LED off

Idle up

- Throttle set between 50% and 100% equals headspeed of 600 - 3000rpm
- +5% = +240rpm

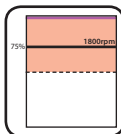

Status LED red or purple

Autorotation

- Throttle in idle position
- When switching back to idle up (>50%) motor will restart quickly
- Switching back to manual control (<40%) will disable governor

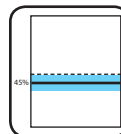

Status LED blue

The second option to control the RPM Governor for **nitro/gas helicopters** is to use a separate switch channel. Here the throttle curves/throttle channel is used for manual throttle servo control only. The RPM Governor is activated and the headspeed is preset by using the additional channel. When the throttle channel is above 25% and a headspeed is preset, the RPM Governor will activate and control this headspeed. Moving the throttle channel below 25% will switch to Autorotation mode.

Manual control

- Throttle curve controls servo
- Governor off
- Governor channel below 5% (-90)

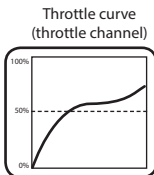

Status LED off

Governor control channel



Idle up

- Governor channel set between 5% and 100% (or -90 and +100 on some transmitters) equals headspeed of 600 - 3000rpm
- +5% (or 10 clicks) = +126rpm
- throttle channel must stay above 25%

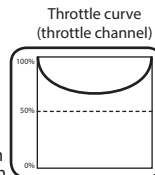

Status LED red or purple

Governor control channel

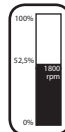

Governor menu point **E** - Signal divider

Electric helicopter with brushless phase sensor or phase signal from ESC: signal divider = motor pole count : 2

Nitro/Gas helicopter with magnetical or optical sensor: signal divider = number of triggers (i.e. magnets or optical markers)

Status LED	off	flashing purple	purple	flashing red	red	flashing blue	blue
E Signal divider	1	2	3	4*	5	6	7

Governor menu points **F** **G** **H** - Main gear ratio

When the helicopter has a single stage main gear: Main gear ratio = Main gear tooth count : Motor pinion tooth count

Set the Status LED color/state at each of the menu points **F**, **G** and **H** so that the main gear ratio can be calculated as sum of the three menu points, i. e. 8.55:1 = **F** flashing purple + **G** purple + **H** flashing red

Status LED	off	flashing purple	purple	flashing red	red	flashing blue	blue	red/blue
F	User defined	8.00	9.00*	10.00	11.00	12.00	13.00	14.00
G	+0.00	+0.20	+0.40*	+0.60	+0.80	-	-	-
H	+0.00	+0.05	+0.10*	+0.15	-	-	-	-

8. FLYING AND OPTIMIZATION

The **tail gyro gain** is adjusted by one of the transmitter's auxiliary channels. The more servo throw this channel produces, the higher the tail gyro gain will be. Additionally the direction of servo throw determines whether the gyro works in Normal-Rate mode or in HeadingLock mode. The color of the Status-LED indicates the selected mode when MICROBEAST PLUS is operational. Purple means Normal-Rate and blue indicates HeadingLock mode. When adjusting the gain and after initialization sequence additionally the amount of gain is displayed by one of the Menu LEDs for 8 seconds.

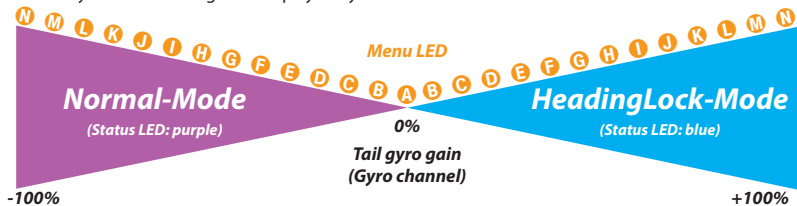

For the first flight we suggest to start with medium gain (not higher than LED **G**) and using HeadingLock mode (Status LED **blue**). In case the tail of the helicopter starts to oscillate in flight immediately reduce the gain! If on the other hand the rudder control feels imprecise and the gyro doesn't hold position very well, increase the gain. Most radio systems provide an automatic switching for the tail gyro gain depending on flight modes. In the flight mode with the lowest rotor headspeed you can use the most tail gain. Reduce the gain the higher the headspeed is. Before the first flight make sure the tail gain is set correctly and is also set when switching flight modes. Use the LED display to see how the gyro is setup and do not rely upon the values of your transmitter as signs and percentages may vary depending on radio brand and radio type!

Before the first take off make a stick direction check and check if swash and tail gyro are correcting to the right direction when you tilt, roll or yaw the helicopter by hand. Just before lift-off make sure that the swashplate is horizontal and that the tail pitch slider is close to center position. Avoid excessive steering during lift-off otherwise the helicopter may tip over! The best way is to give a fair and direct collective pitch input to lift the helicopter quickly up into the air.

Adjusting the **three dials** on top of MICROBEAST PLUS you can optimize the control loop and customize it to your helicopter. For the first flight all three dials should be centered. If necessary only adjust one dial at a time and only in little steps. Turning a dial clockwise will increase the effect, turning it counter-clockwise will decrease the effect of the parameter.

1 - Cyclic gain

The higher the gain the harder the helicopter will stop after cyclic moves and the more stable and precise the helicopter will fly. If the gain is too high the helicopter will shake quickly (especially on the elevator axis) as the system overcompensates. Due to their low mass this behavior will occur sooner on small helicopters, so typically these do not need as much gain as large helicopters. With low gain the helicopter does not stop precisely and overshoots after a cyclic movement. Additionally it is unstable and control feels sluggish.

2 - Cyclic feed forward

Feed forward directly connects the servo movements to your stick inputs bypassing the control loop. This will give a more natural stick feeling and quicker reactions to stick inputs. But if the cyclic feed forward is too high stick control will fight against the control loop. The heli will bounce back when stopping from a cyclic movement and it will react over sensitive and pitch up easily in fast forward flight.

3 - Tail gyro response

Increasing the tail gyro response will lead to harder stopping and more aggressive response to rudder stick inputs. If response is set too high the tail will bounce back when doing a hard stop (especially when turning against rotor torque). If the dynamic is set too low the rudder control feels dull and stopping might be too soft. Ideally the tail should stop perfectly to the point without making any flapping noises.

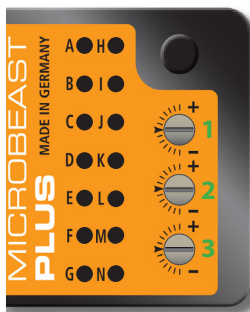

9. PARAMETER MENU

The Parameter menu allows you to further customize the flight characteristics of the helicopter and the reaction of the system to control inputs. You can find a detailed description for each parameter in the MICROBEAST PLUS instruction manual.

Entering Parameter menu

Press and hold button



Operation mode
(Status LED is
blue or purple)

Release button



Menu LED **A** flashing



Menu LED **A** flashing
(= Parameter menu point **A**)

Menu point **A** - Swashplate quick trim (Menu LED **A** flashing)

Move the stick(s) for aileron and elevator to trim the swashplate into the desired direction. When using the tail gyro in Normal-Rate mode you can store the last servo position by pressing and holding the button for 2 seconds. To delete all trimmings that have recently been made briefly push the rudder stick.

Menu points **B** to **K**

Color and state of the Status LED indicate which option is currently selected at each menu point. By pushing the rudder stick repeatedly you can cycle through the available options at each menu point and change the setting if necessary. Briefly pushing the button will skip to the next menu point. After the last menu point the system will exit Parameter menu and change back to operation mode.

Status LED	off	purple	flashing red	red	flashing blue	blue
B Control style	User defined	normal	sport*	pro	extreme	TX mode
C Speed flight stability	User defined	very low	low	medium*	high	very high
D Rudder rate consistency	User defined	very low	low	medium*	high	very high
E Stick deadzone	User defined	very small	small*	medium	large	very large
F Torque precompensation	User defined	off	low - nor.	high - nor.	low - inv.	high - inv.
G Cyclic response	User defined	normal*	slightly increased	increased	aggressive	very aggressive
H Pitch boost	User defined	off*	low	medium	high	very high
I Throttle response	soft	normal*	slightly increased	increased	aggressive	very aggressive
J Slow rampup speed	User defined	50 rps	100 rps	200 rps*	300 rps	400 rps
K Fast rampup speed	User defined	using slow rampup speed	300 rps	500 rps*	700 rps	900 rps

10. ATTITUDECONTROL (OPTIONAL)

Parameter menu point **L** - AttitudeControl mode

AttitudeControl can be used to level the helicopter automatically by the flip of a switch. This provides different applications i.e. to use as bail out rescue in case the pilot loses orientation, to have a training aid for learning new flight maneuvers or to use as stabilization for camera flights. At Parameter menu point **L** you can choose between different operation modes and applications that determine how the helicopter will be stabilized exactly when activating AttitudeControl in flight. Please see the instruction manual for further reference. For the beginning we recommend using the „Rescue mode with pitch control“.

Status LED	off	flashing purple	purple	flashing red	red	blue
L AttitudeControl Operation mode	AttitudeControl disabled*	Bail out rescue	Bail out rescue w. pitch control	3D Mode	3D Mode w. pitch control	Flight trainer

Parameter menu point **M** - AttitudeControl pitch

When you choose an AttitudeControl mode „with pitch control“ at menu point **L** additionally menu point **M** will appear after pressing the button at **L**. Here you can adjust the collective pitch that will be used when AttitudeControl is activated and the heli is hovering stable. Use the stick for aileron to adjust the pitch if necessary.

Programming the transmitter

In case AttitudeControl has been enabled at Parameter menu point **L** you can activate it in flight by moving the channel for AttitudeControl into one direction. There are 2 options for the control channel: Either you use a separate switch channel that can be assigned in Receiver setup menu (or which is set by default) or you use the tail gyro gain channel also for adjusting AttitudeControl. While in operation mode you can check if activating AttitudeControl is working properly. Whenever the AttitudeControl status changes the Status LED will light solid red and the Menu LEDs indicate whether AttitudeControl is on or off and how strong it will react. After 8 seconds the display changes back to showing the tail gyro operation mode.

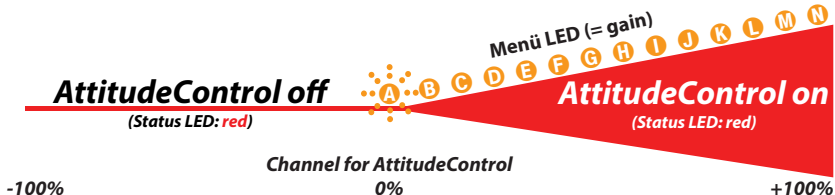

For the first flight it is recommended to adjust the throw of the AttitudeControl channel just until Menu LED **G** lights up when AttitudeControl is activated with the switch on the transmitter. Later onwards you may increase or decrease the throw which determines how fast and violent the helicopter will be rotated back to and held in horizontal position. If the switch channel is in „AttitudeControl off“ position the amount of throw is not of importance for AttitudeControl (in case this switch channel doesn't control the tail gyro as well, see next page).

If switching AttitudeControl works the other way round (one of the Menu LEDs **B** - **N** lights up when the AttitudeControl switch is in „off“-Position and you can't increase further than Menu LED **A** when the switch is in „on“-Position) then reverse the channel for AttitudeControl by using the servo reverse function of your transmitter.

If using the tail gyro control channel also for AttitudeControl the amount of throw determines as usual the height of gyro gain when switched into direction „AttitudeControl off“. Moving the channel by using a switch into the other direction the amount of tail gyro gain will be stored temporarily and AttitudeControl is activated. The amount of throw into this direction determines the height of AttitudeControl gain.

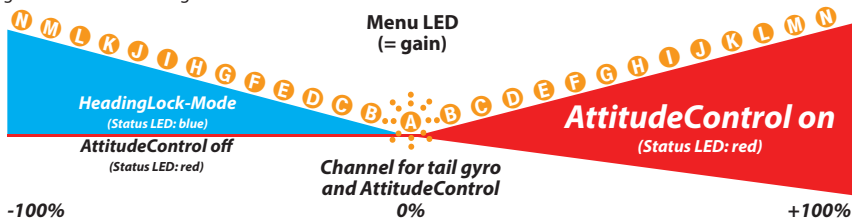

⚠ When using AttitudeControl with combined switch channel make sure AttitudeControl is at least deactivated once before take off. Otherwise the tail gyro gain would be minimal as the system would not yet have been able to determine your tail gain setting after initialization.

⚠ With this type of operation it is absolutely necessary to use a switch that changes the control directions directly and without intermediate steps. In particular, do not use a slider or delay function for switching the gain channel on the transmitter! Otherwise, when you activate AttitudeControl the tail gyro sensitivity would be decreased to 0% at first before the system turns on the AttitudeControl. You would have 0% of tail gyro gain when AttitudeControl is active as the system stores the last valid tail gyro value!

Functional test of AttitudeControl

When activating AttitudeControl you should be able to see an immediate impact on the swashplate control: If the heli is tilted to one side, MICROBEAST PLUS permanently steers the swashplate opposed to the inclination. In the region around horizontal position the swashplate will always stay nearly horizontal to the ground. The system constantly tries to bring the helicopter back to the horizontal position as long as the helicopter is oblique.

Tilt the helicopter forwards, backwards or to the side

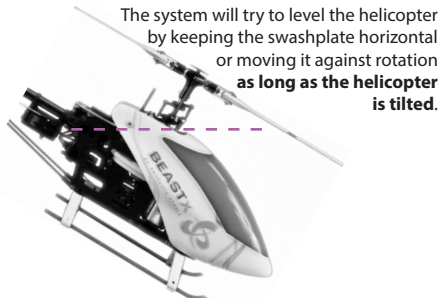

If on the other hand AttitudeControl is deactivated the system will only counteract sudden movements but will not control the swashplate as long the heli is not moved even in tilted position.



SETUP MENU

(Menu LED solid)

	off	flashing purple	purple	flashing red	red	flashing blue	blue	flashing red/blue
A Device orientation	horizontal socket in front	vertical socket in front	hor. inv. socket in front	vert. inv. socket in front	horizontal socket at back	vertical socket at back	hor. inv. socket at back	vert. inv. socket at back
B Swashplate servo update rate	User defined		50 Hz*	65 Hz	120 Hz	165 Hz	200 Hz	
C Rudder servo center pulse	User defined		960 µs		760 µs		1520 µs*	
D Rudder servo update rate	User defined		50 Hz*	165 Hz	270 Hz	333 Hz	(560 Hz)	
E Rudder servo limit	Use rudder stick to move servo to right endpoint and wait, then left endpoint and wait (or vice versa).							
F Tail gyro direction					normal*		inverted	
G Swashplate servo trim	reference position		Servo CH1		Servo CH2		Servo CH3	
H Swashplate mixing type	User defined		mechanical	90°	120°*	140°	135°/140°(1:1)	
I Swashplate servo directions	nor inv inv		nor nor inv*		nor inv nor		nor nor nor	
J Swashplate servo throw	Use aileron stick to adjust 6° cyclic pitch on the roll axis to one direction (blades aligned with fuselage).							
K Collective pitch	Set collective stick to max/min position and use aileron stick to adjust desired pitch. Set pitch direction by rudder stick input: Status-LED blue = positive pitch, red = negative pitch.							
L Swashplate servo limit	Move aileron, elevator and thrust stick. Adjust maximum limit by rudder stick input.							
M Swashplate gyro directions	inv inv		inv nor		nor inv		nor nor*	
N Internal RPM Governor	Governor off*				electric heli		nitro/gas heli	

GOVERNOR SETUP MENU

(Menu LED flashing slowly)

	off	flashing purple	purple	flashing red	red	flashing blue	blue	flashing red/blue
A Test mode								„nitro/gas heli“: Status-LED blue when magnet passes sensor „electric heli“: Status-LED red when motor is running
B Motor off/Idle position								„nitro/gas heli“: throttle servo to (increased) idle position „electric heli“: throttle „in_motor off“ position, just before motor starts
C Full throttle position	Set throttle channel/throttle servo to full throttle position.							
D Transmitter setup	RPM Governor off		RPM Governor maximum		RPM Governor on		RPM Governor autorotation	
E Signal divider	1	2	3	4*	5	6	7	
F Main gear ratio	User defined	8	9*	10	11	12	13	14
G (Sum out of F + G + H if not „User defined“ at menu point F)	+0.00	+0.20	+0.40*	+0.60	+0.80			
H	+0.00	+0.05	+0.10*	+0.15				

* Default setting

PARAMETER MENU

(Menu LED flashing quickly)

	off	flashing purple	purple	flashing red	red	flashing blue	blue
A Swashplate quick trim / AttitudeControl trim	Use aileron and elevator stick to trim, hold button 2s to trim rudder. Reset all by rudder stick input. Switch trim mode by activating AttitudeControl using the AttitudeControl switch channel.						
B Control style	User defined		normal	sport*	pro	extreme	TX mode
C Speed flight stability	User defined		very low	low	medium*	high	very high
D Rudder rate consistency	User defined		very low	low	medium*	high	very high
E Stick deadzone	User defined		very small	small*	medium	large	very large
F Torque precompensation	User defined		off	low - nor.	high - nor.	low - inv.	high - inv.
G Cyclic response	User defined		normal*	slightly increased	increased	aggressive	very aggressive
H Pitch boost	User defined		off*	low	medium	high	very high
I Throttle response	soft		normal*	slightly increased	increased	aggressive	very aggressive
J Slow rampup speed	User defined		50 rps	100 rps	200 rps*	300 rps	400 rps
K Fast rampup speed	User defined		using slow rampup speed	300 rps	500 rps*	700 rps	900 rps
L AttitudeControl mode	AttitudeControl disabled*	Bail out rescue	Bail out rescue w. pitch control	3D Mode	3D Mode w. pitch control		Flight trainer
M (AttitudeControl pitch)	Adjust by giving aileron stick input. Reset with rudder stick input.						

RECEIVER MENU

(Menu LED flashing)

	off	flashing purple	purple	flashing red	red	flashing blue	blue
A Receiver type	Standard*	JR® R01 remote satellite	Spektrum® remote satellite	Futaba® S-BUS	SRXL	SPPM	
B Collective pitch							
C Aileron	• Status-LED light up in blue color if valid incoming signal from receiver.						
D Elevator							
E Rudder	• Move the stick/channel on the transmitter you want to assign. The Status-LED will flash briefly in case the movement has been detected.						
F Tail gyro gain							
G Throttle [CH5]	• Menu points ① , ② and ③ can be skipped in case you don't want to use the specific function or if you want to use nitro RPM Governor and/or AttitudeControl without separate switch channel.						
H Auxiliary [CH6] (optional)							
I RPM Governor (optional)	• To load the default channel assignment keep the button pressed at any menu point. You will directly jump to menu point ④ .						
J AttitudeControl (optional)							
N Throttle failsafe position	Move throttle to failsafe position and push button to save all menu items and exit menu.						

* Default setting

Please note: Not all menu items may be accessible. This depends on installed firmware and upgrade level.

DECLARATION OF CONFORMITY

We

BEASTX GmbH
Karl-Ferdinand-Braun-Str. 33
50170 Kerpen
Germany

herewith declare that **MICROBEAST PLUS** / **MICROBEAST PLUS HD** meet all the essential requirements of the Directives 2004/108/EC und 2011/65/EU. For the evaluation of compliance with these Directives the following standards where applied:

EN 61000-6-1:2007
EN 61000-6-3:2007 + A1:2011 + AC:2012

The products carry the CE mark:



The products mentioned above are fully compliant with requirements stipulated by REACH (1907/2006/EC) and RoHS (2011/65/EC), where applicable. Furthermore, the articles and their packaging materials do not contain substances included on the current candidate list for authorization (SVHC list) according to Art. 33 and 59(1, 10) REACH in a concentration above 0.1 % weight by weight. The candidate list and its updates are closely monitored on a regular basis. In addition, our products do not contain any substances subject to authorization or restriction (REACH Annexes XIV and XVII).

Kerpen, 01.08.2014

place and date of issue

Markus Schaack, CEO

name and signature

LEGAL TERMS

All statements in this document have been checked for accuracy, integrity and actuality. However, potential mistakes cannot be excluded. We are not responsible for any damage which occurs as a result of these contents.. Do not hesitate to send us any suggestions for improvement by e-mail to info@beastx.com.

This product contains chemicals known to the State of California to cause cancer, birth defects or other reproductive harm.

The actual contents of this publication are protected by copyright law. All rights reserved.

BEASTX, **MICROBEAST** and **SRXL** are registered trademarks.